

N:\Data\SURVEY PROJECTS\90000-90099\90001 Marty Gell Ashlee Road\07 - Engineering\02 - Drawings & Sketches (Eng)\90001 Base.dwg

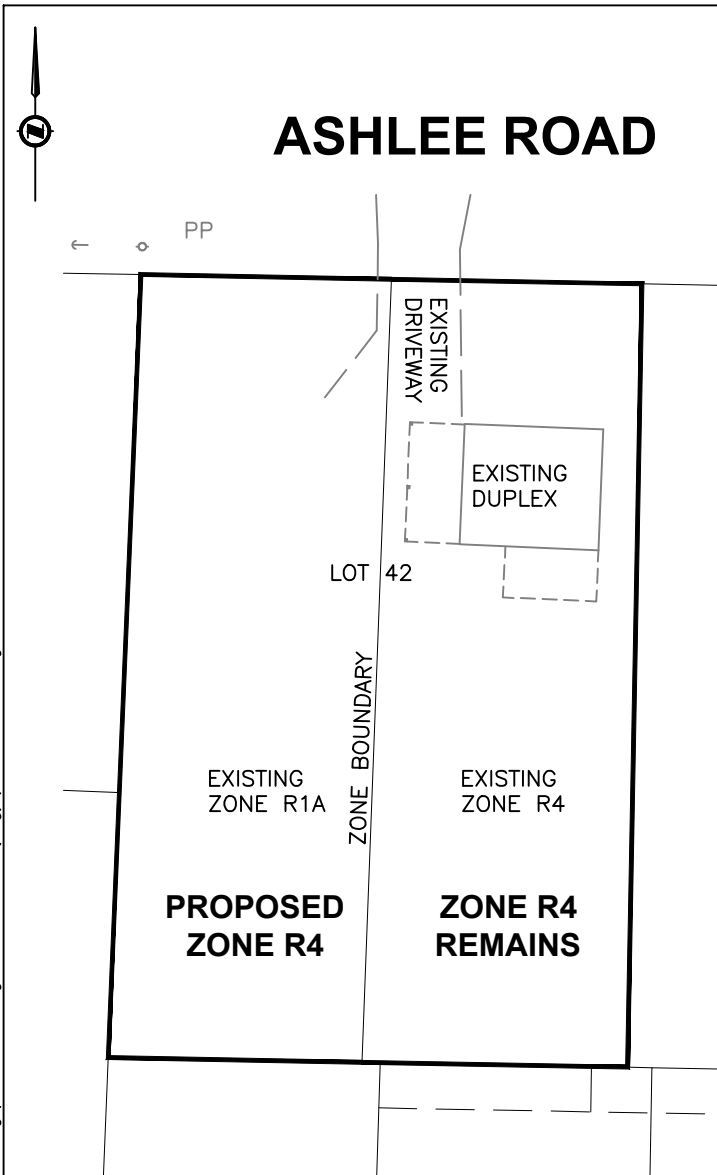

- PROPOSED ZONING AMENDMENT FROM R1A SINGLE RESIDENTIAL ON PORTION OF LOT 42 TO R4 DUPLEX RESIDENTIAL OVER ALL OF LOT 42

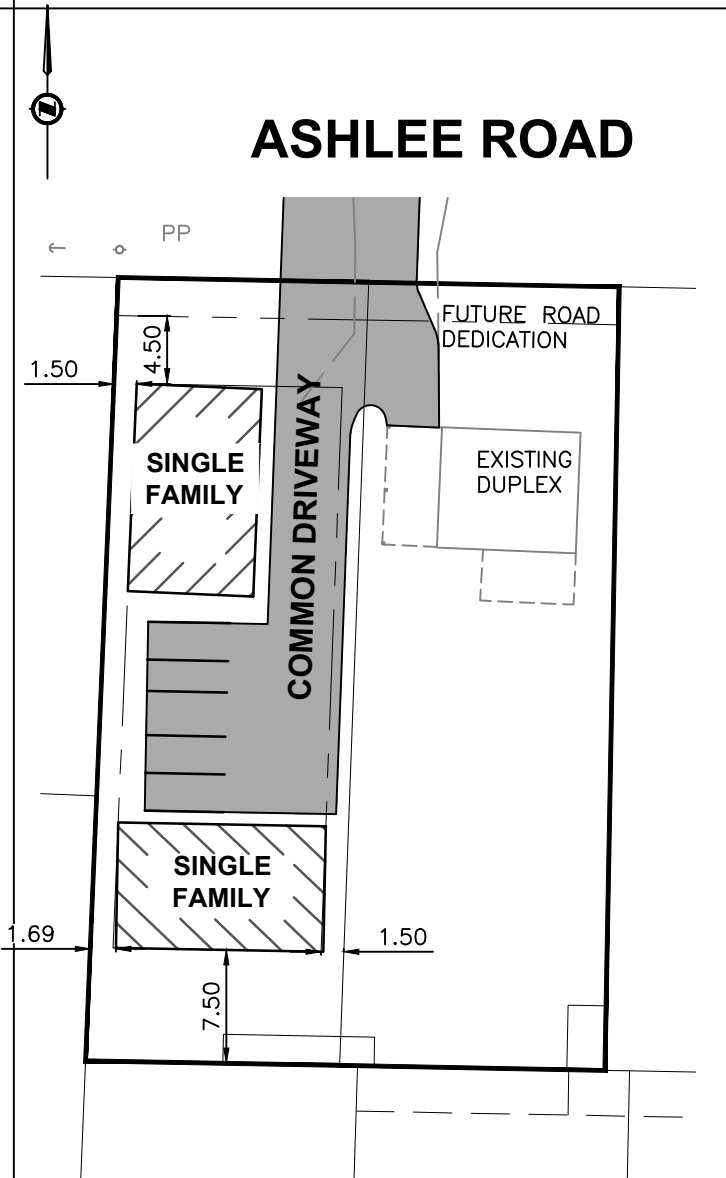

A POSSIBLE DEVELOPMENT OF THE SITE COULD INCLUDE:

1. SUBDIVISION OF LOT 42 INTO 2 LOTS
2. CONSTRUCT 2 SINGLE FAMILY RESIDENCES WITH APPROXIMATELY 1200 sq.ft. FOOTPRINTS
3. REMOVE THE EXISTING DRIVEWAY AND COMBINE WITH A SHARED DRIVEWAY TO THE NEW RESIDENCES.
4. PARKING WOULD BE LOCATED BETWEEN THE RESIDENCES.



**J.E. ANDERSON
& ASSOCIATES**

SURVEYORS - ENGINEERS

VICTORIA NANAIMO PARKSVILLE CAMPBELL RIVER

#1A-3411 SHENTON ROAD, NANAIMO, BC. V9T 2H1

PHONE: 250-758-4631 EMAIL: nanaimo@jeanderson.com WEB: www.jeanderson.com

DRAWN: JWT

SCALE: 1:500

DATE: 20230821

SHEET 2 OF 3

CLIENT

ARAM KARAKAS

PROJECT

**2265 ASHLEE ROAD
ZONING AMENDMENT PROPOSAL**

90001 01 ZD2

ENG:

RECEIVED

RA483

2023-SEP-12

Current Planning